

Installing ZIP System® Tape on Inside Corners

This Tech Tip is designed to help installers of ZIP System® sheathing install ZIP System tape tightly into an inside corner. Inside corners can be challenging for new users of ZIP System sheathing to install properly. Fortunately, there is a fast and easy way to effectively tape inside corners when installers follow the recommendations shown below. Please also see a detailed installation video of taping inside corners at <https://youtu.be/GKWbHAR296s>.

Step 1: When installing ZIP System tape into an inside corner, use an arm's length of tape at a time. Once you have the proper length of tape hold each end of the tape with your fingers and pop the tape in opposite directions.

This will cause the tape to fold back on itself making it easier to work the adhesive side of the tape into the inside corner.

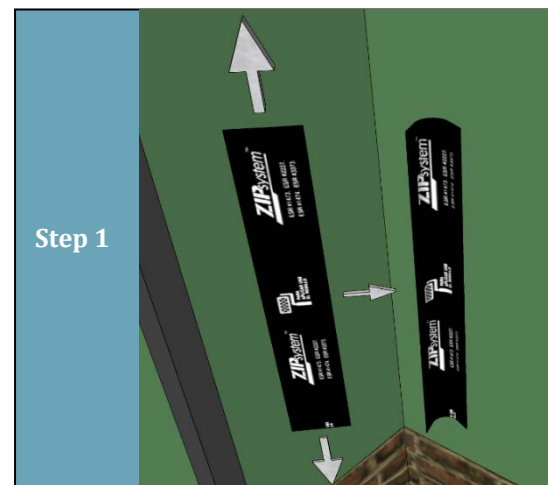

Step 2: Now that the tape is folded back on itself, adhere the tape to a panel starting at the bottom of the wall. For ease of installation start by apply the tape onto one panel and use a plastic tool to work the tape towards the corner.

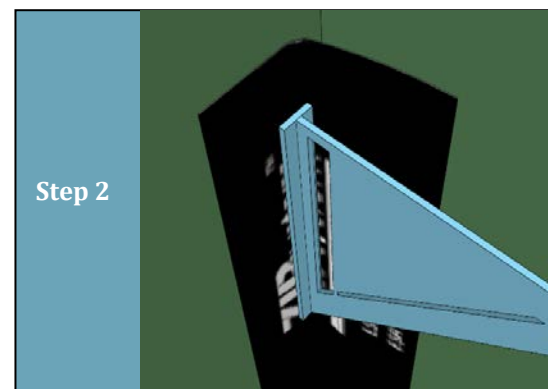

Step 3: After the tape has been tightly fitted into the corner with the plastic tool, use the same plastic tool to work the tape on the other panel.

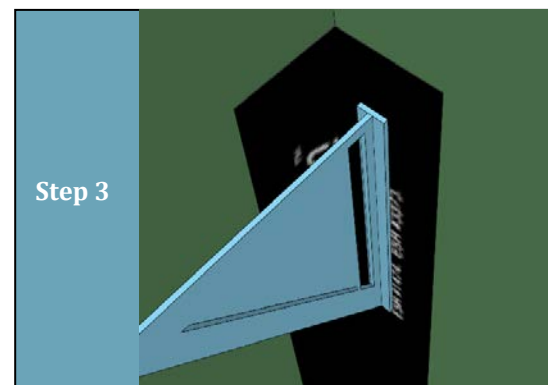

Step 4: After the tape has been installed. Use the ZIP System roller, or similar, to roll the ZIP System tape.

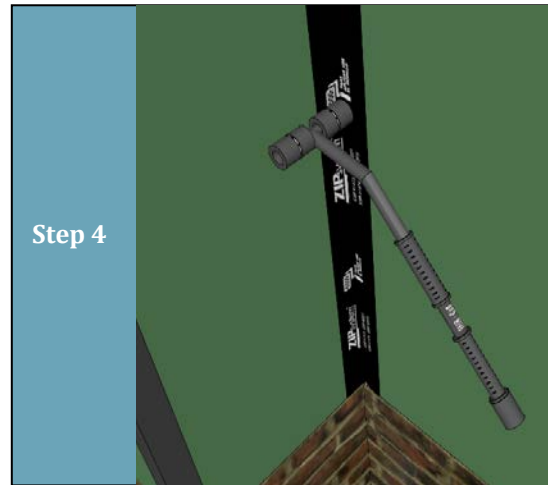

Step 5: When installing multiple pieces of tape, ensure the top piece of tape overlaps the bottom piece of tape a minimum of 3 inches.

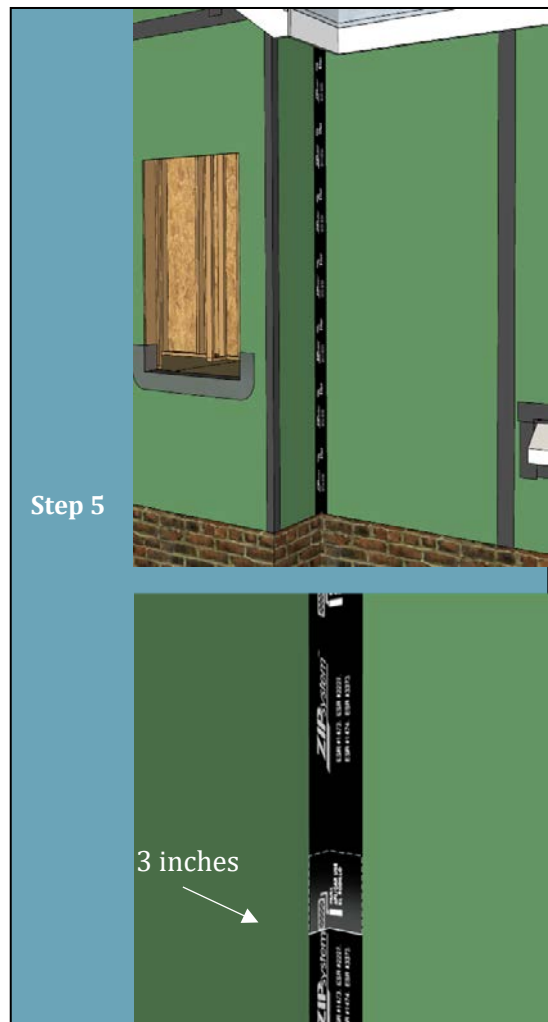

Please visit zipsystem.com or contact our technical department at 800-933-9220 Ext 2716 or at techquestions@huber.com with any questions or comments.