



**ZIP SYSTEM ROOF SHEATHING GENERAL NOTES**

ZIP SYSTEM® SHEATHING IS A WOOD STRUCTURAL PANEL WITH INTEGRATED, PROTECTIVE OVERLAY THAT ELIMINATES THE NEED FOR BUILDING WRAP OR ROOF FELT. IT IS CODE RECOGNIZED IN ICC-ES ESR-1473 AS AN ALTERNATE TO THE UNDERLAYMENT REQUIRED IN THE IBC AND IRC, AND SATISFIES THE REQUIREMENTS FOR AIR BARRIERS AS DEFINED IN THE ICC INTERNATIONAL ENERGY CONSERVATION CODE.

THE OSB WOOD STRUCTURAL PANEL SUBSTRATE IS AVAILABLE IN 7/16", 1/2" OR 5/8" THICKNESSES AND CARRIES THE EXPOSURE 1 BOND CLASSIFICATION. 7/16" PANELS HAVE A GREEN OVERLAY WHILE 1/2" AND 5/8" ARE IDENTIFIED BY THEIR "SIENNA RED" COLOR. THE ORIENTED STRAND BOARD (OSB) SUBSTRATE SATISFIES THE PROVISIONS OF U.S. DEPARTMENT OF COMMERCE VOLUNTARY PRODUCT STANDARD 2 (PS2) PERFORMANCE STANDARD FOR WOOD-BASED STRUCTURAL-USE PANELS AS SPECIFIED IN SECTION 3.1 OF THE EVALUATION REPORT. IT IS THIRD PARTY CERTIFIED AS A STRUCTURAL 1 SHEATHING PANEL FOR ALL THICKNESSES. REFER TO CHAPTER 23 OF THE INTERNATIONAL BUILDING CODE FOR ALLOWABLE SHEAR VALUES FOR WALL SHEATHING WHEN DESIGNING SHEAR WALL USING ZIP SYSTEM® SHEATHING. FASTENER TYPE AND SPACING DO NOT AFFECT THE PERFORMANCE OF ZIP SYSTEM SHEATHING TO FUNCTION AS A WATER-RESISTIVE AND AIR BARRIER. WHEN USED ON A ROOF, APPROVED ROOF COVERINGS INCLUDE ASPHALT SHINGLES, SLATE, TILE, CEDAR SHINGLES, METAL SHINGLES AND METAL PANELS ON BUILDINGS OF TYPE V CONSTRUCTION AND CONSTRUCTION PERMITTED UNDER THE IBC AND IRC.

**ZIP SYSTEM SHEATHING - ROOF INSTALLATION INSTRUCTIONS**

1. INSTALL ZIP SYSTEM SHEATHING PANELS WITH THE WATER-RESISTIVE BARRIER FACING OUT. PANELS MUST BE ORIENTED PERPENDICULAR TO FRAMING. SPACE PANELS A MIN. 1/8".
2. FASTEN THE PANELS TO THE FRAMING USING CODE APPROVED FASTENERS WITH MAXIMUM SPACING OF 6" O.C. ALONG SUPPORTED EDGES AND 12" O.C. AT INTERMEDIATE SUPPORTS. IT IS THE RESPONSIBILITY OF THE GENERAL CONTRACTOR TO VERIFY THE PROPER INSTALLATION AND LOCATION IN THE FIELD. THE GC IS RESPONSIBLE FOR ENSURING OVER-DRIVEN FASTENERS AND SHINERS ARE ADDRESSED.
3. TAPE ALL SEAMS USING ZIP SYSTEM FLASHING TAPE ENSURING THE TAPE IS CENTERED OVER THE SEAM WITHIN ± 1/2". USE THE ZIP SYSTEM TAPE GUN OR ROLLER TO APPLY ADEQUATE PRESSURE AND SMOOTH OUT ANY WRINKLES.
4. VERTICAL OR HORIZONTAL TAPE SPLICES SHOULD OVERLAP A MIN. 3". AT T-JOINTS, THE TAPE PIECES SHOULD OVERLAP A MIN. 1".
5. THE DETAILS SHOWN ON THIS PAGE ARE TYPICAL AND FOR GENERAL PURPOSE. VISIT [WWW.ZIPSYSTEM.COM](http://WWW.ZIPSYSTEM.COM) FOR MORE INFORMATION ON OTHER FINISHED ROOF COVERINGS OR APPLICATIONS, TO VIEW THE INSTALLATION MANUAL, AND FOR A LIBRARY OF DETAILS AND TECHNICAL TIPS.

**6. LOAD SPAN TABLES<sup>9</sup>**

ZIP SYSTEM® SHEATHING MAXIMUM ALLOWABLE TOTAL UNIFORMS ROOF LOAD (PSF)				
SPAN RATING	THICKNESS	16' O.C.	19.2' O.C.	24' O.C.
24/16	7/16"	180	125 <sup>9</sup>	68 <sup>9</sup>
32/16	1/2"	209	145	93
40/20	5/8"	283	232	156

- a. BASED ON L/360 DEFLECTION, NORMAL DURATION OF LOAD, 3-SPAN CONDITION, DRY END-USE CONDITIONS AND MINIMAL PANEL OF 24-INCHES.  
 b. H-CLIPS REQUIRED

**HUBER ENGINEERED WOODS LLC**  
**10925 DAVID TAYLOR DRIVE**  
**SUITE 300**  
**CHARLOTTE, NC 28262**  
**1-800-933-9220**

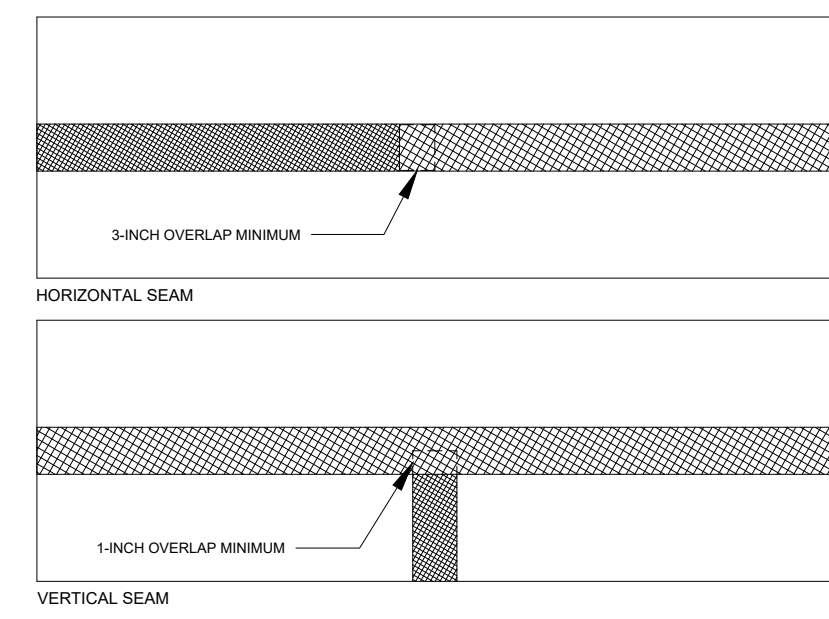

NOTE: THE VERTICAL TAPE SHOULD BE A MINIMUM OF 1" FROM THE EDGE OF THE HORIZONTAL TAPE AND BE INSTALLED FLAT AGAINST THE PANEL.

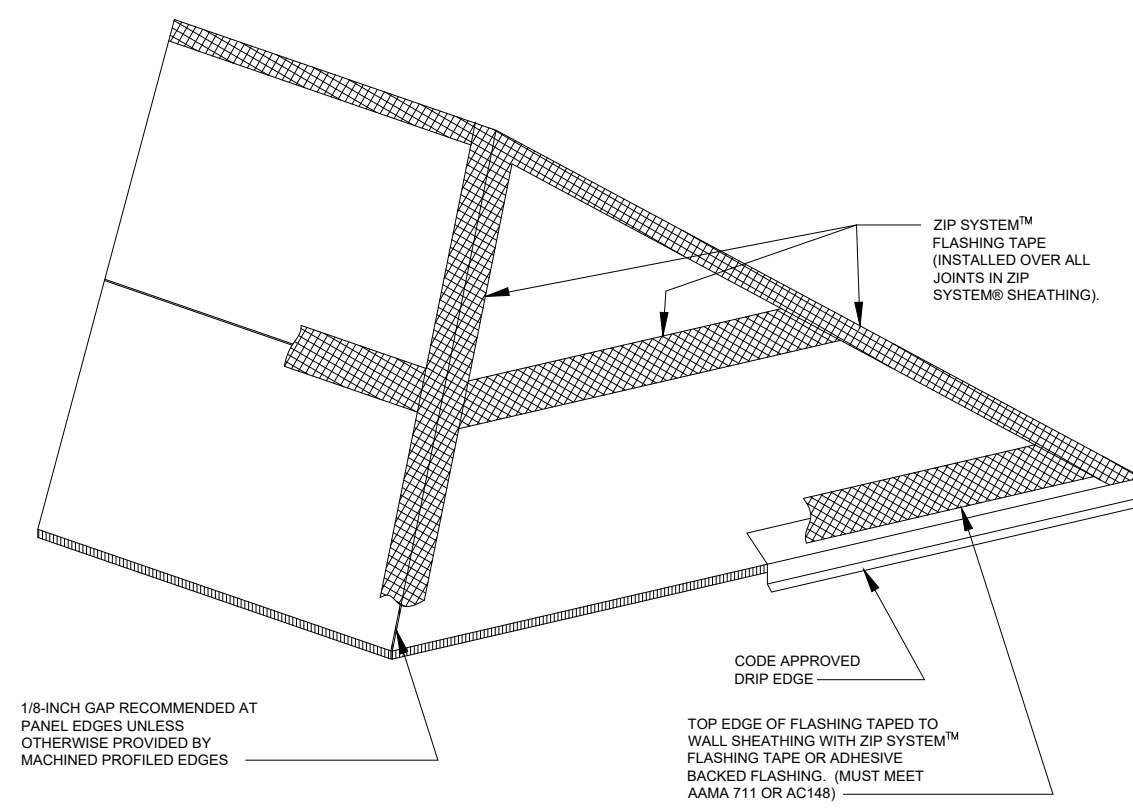

NTS

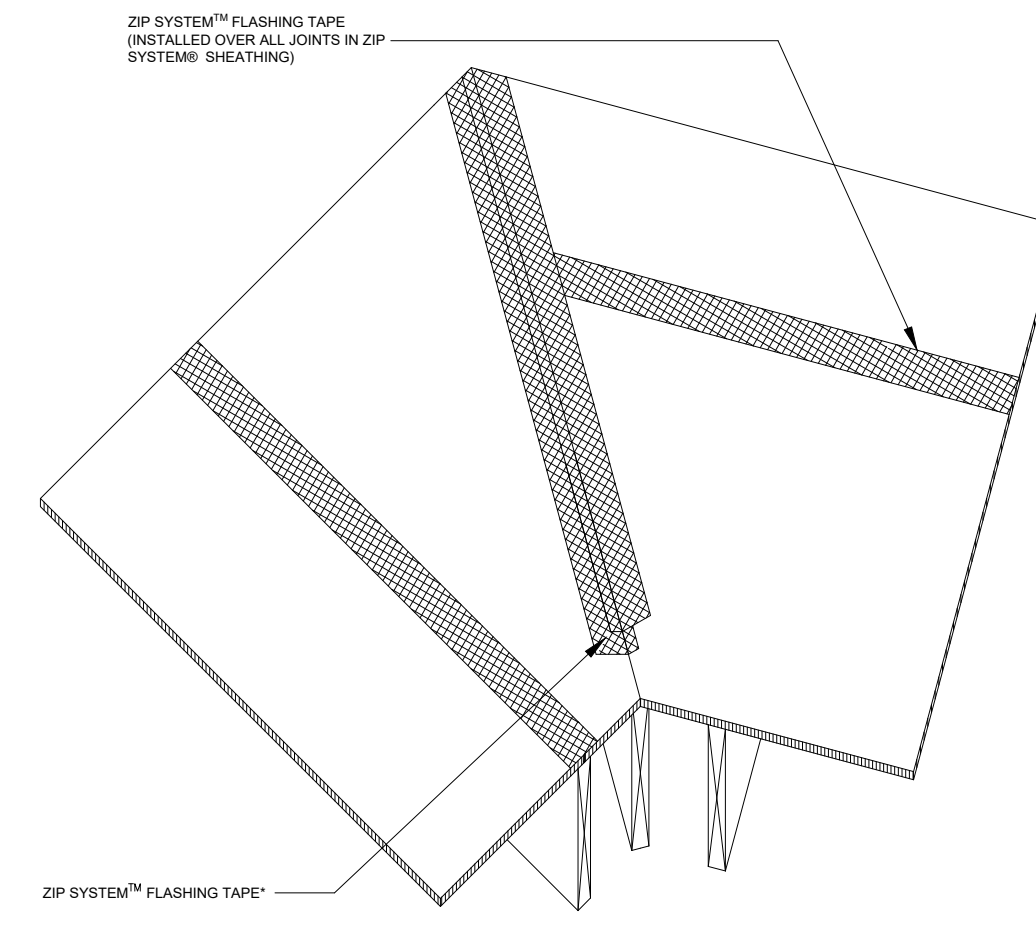

NTS

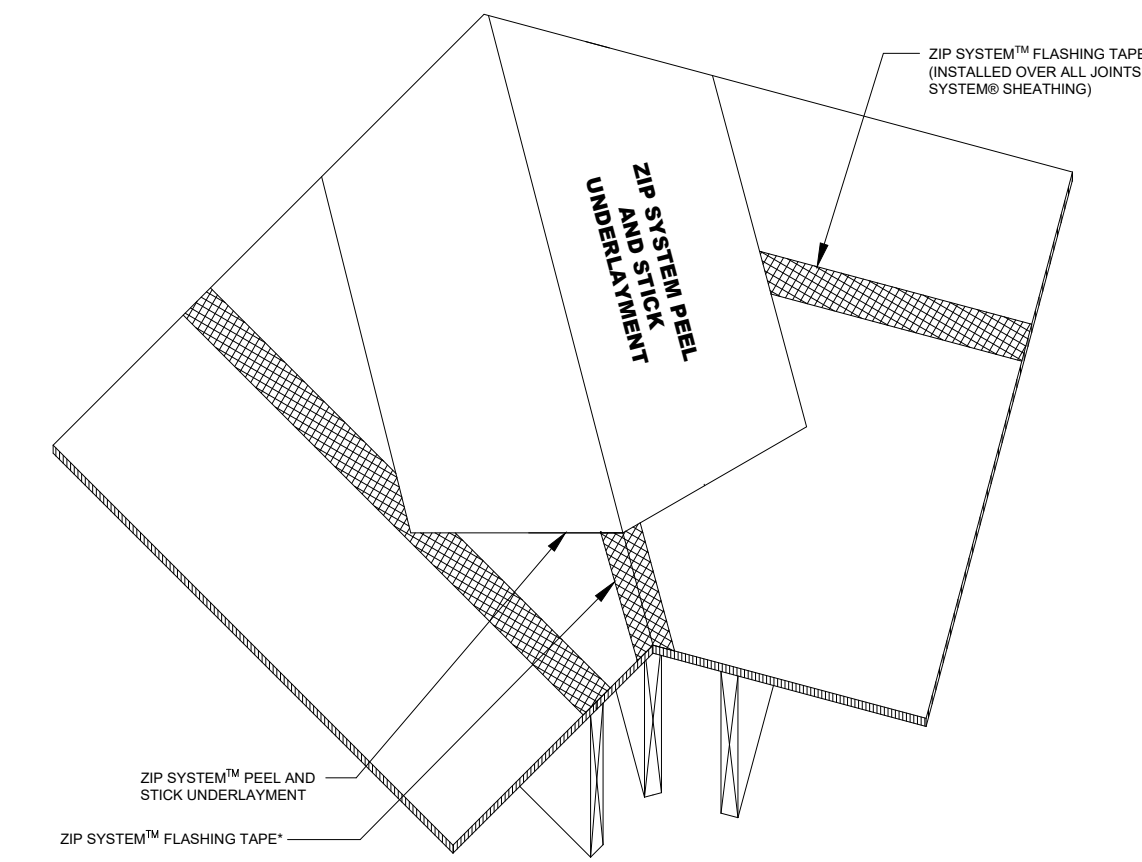

NTS

**Z-1 ZIP SYSTEM TAPE AT OVERLAP**

**Z-2 ZIP SYSTEM SHEATHING AT HIP FLASHING**

**Z-3 ZIP SYSTEM SHEATHING AT VALLEY FLASHING - OPTION A**

**Z-4 ZIP SYSTEM SHEATHING AT VALLEY FLASHING - OPTION B**

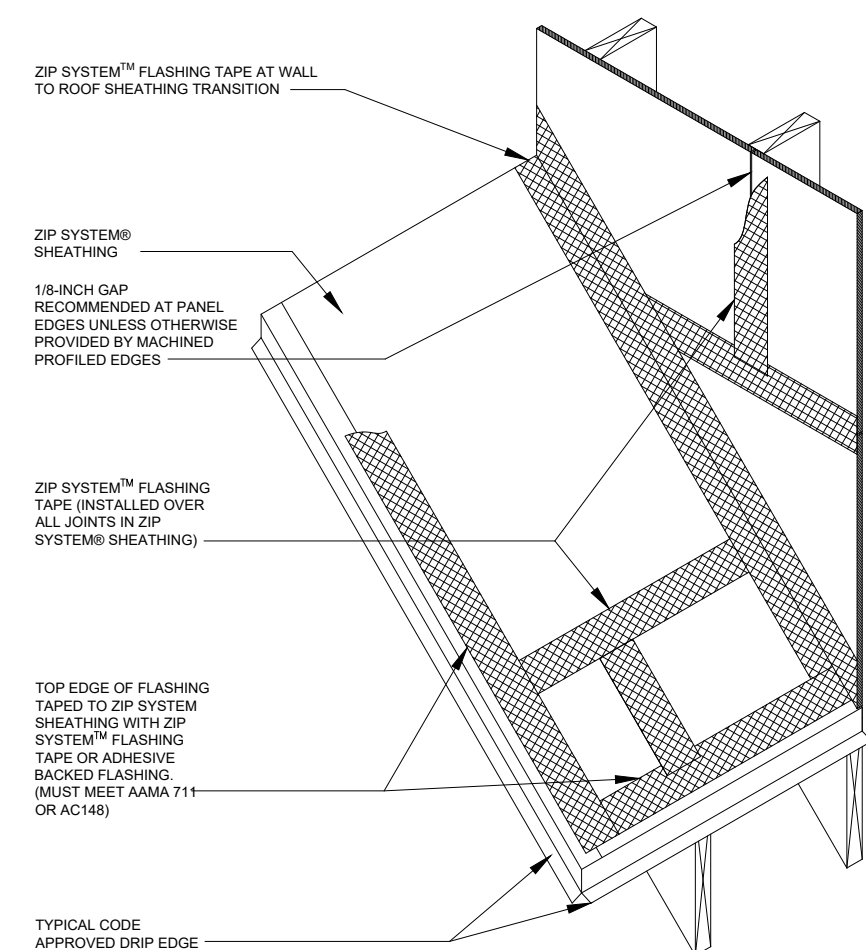

NTS

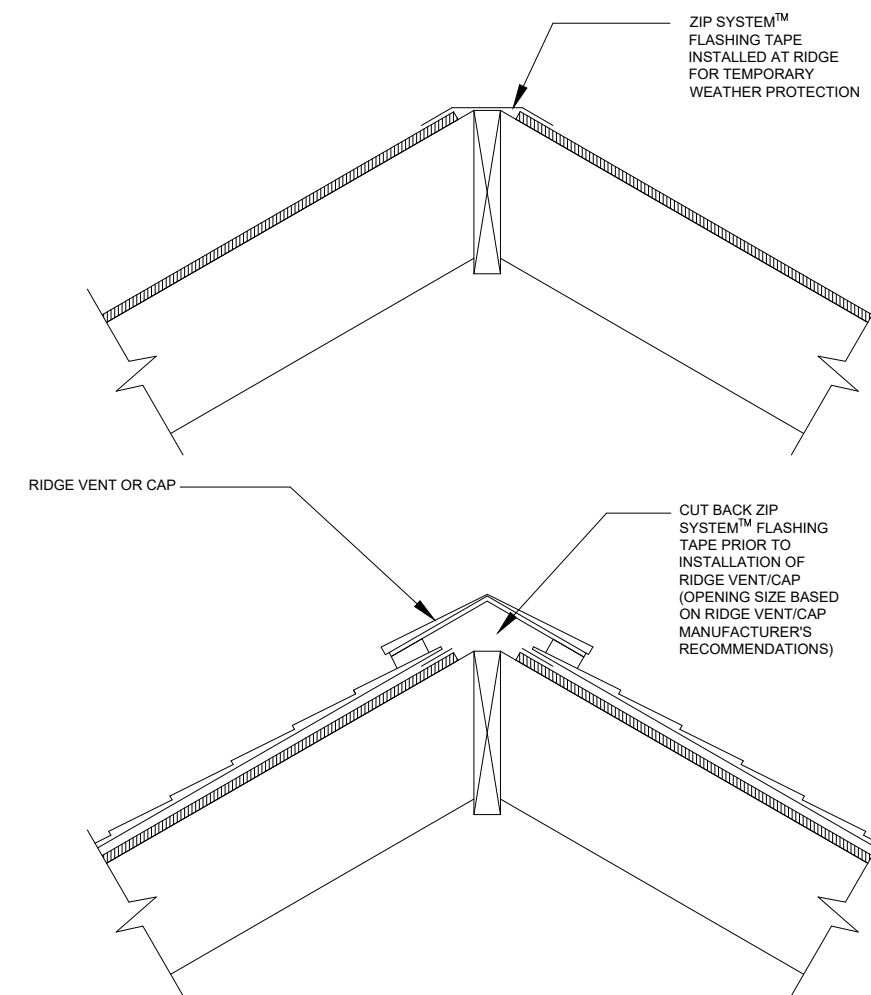

NTS

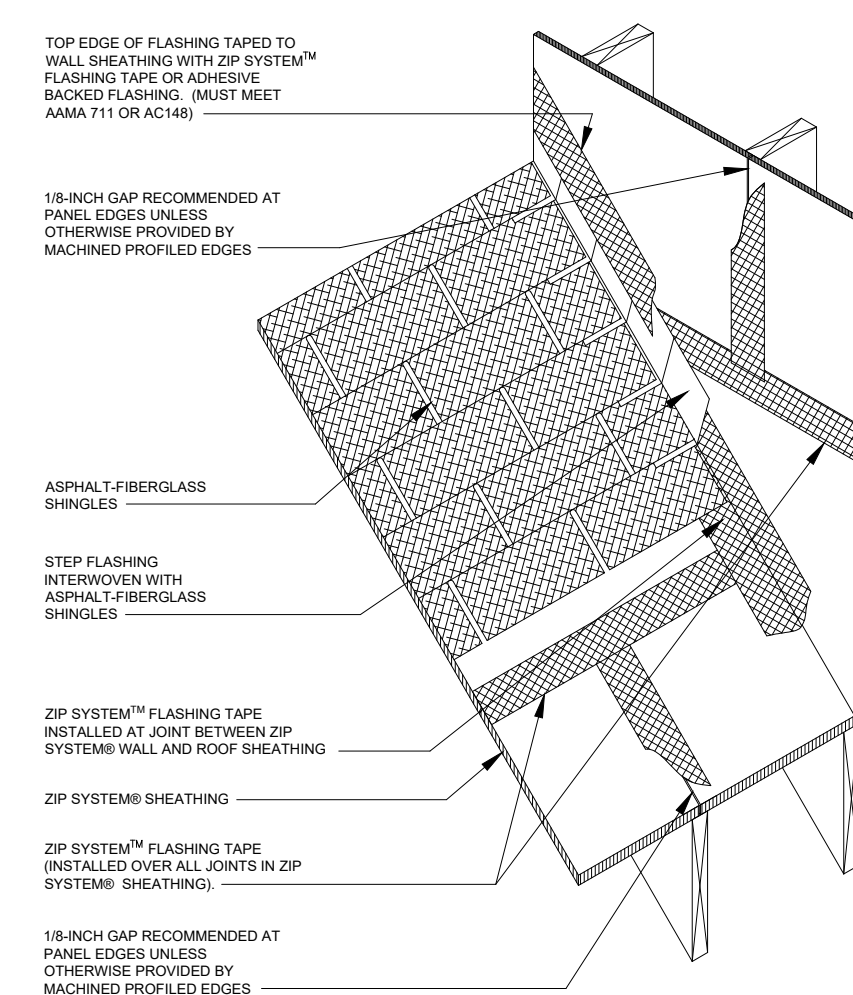

NTS

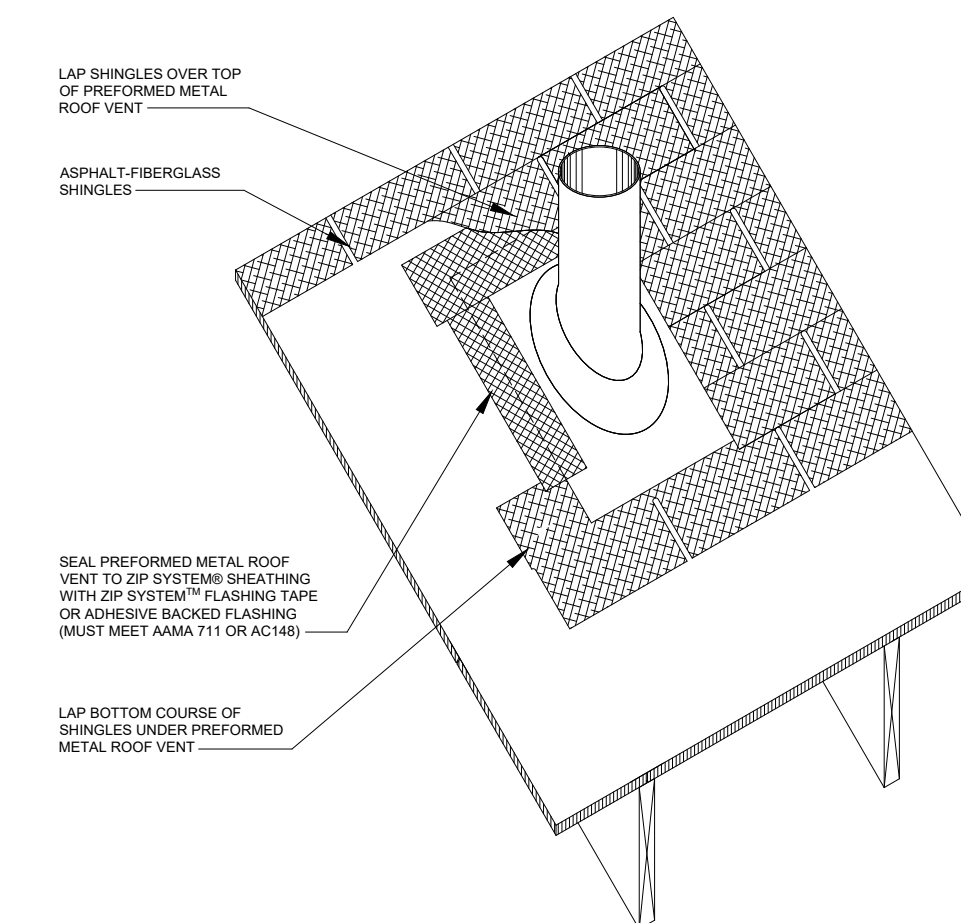

NTS

**Z-5 ZIP SYSTEM SHEATHING AT DRIP EDGE**

**Z-6 ZIP SYSTEM SHEATHING AT RIDGE**

**Z-7 ZIP SYSTEM SHEATHING AT STEP FLASHING**

**Z-8 ZIP SYSTEM SHEATHING AT PLUMBING VENT**

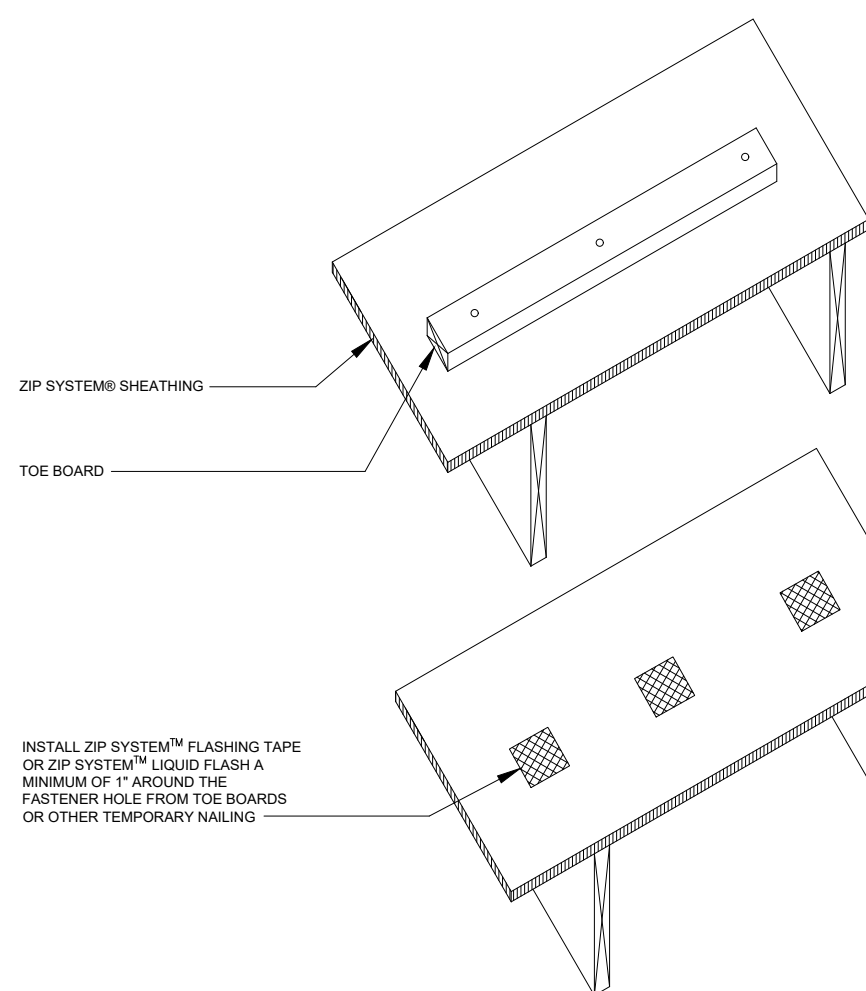

NTS

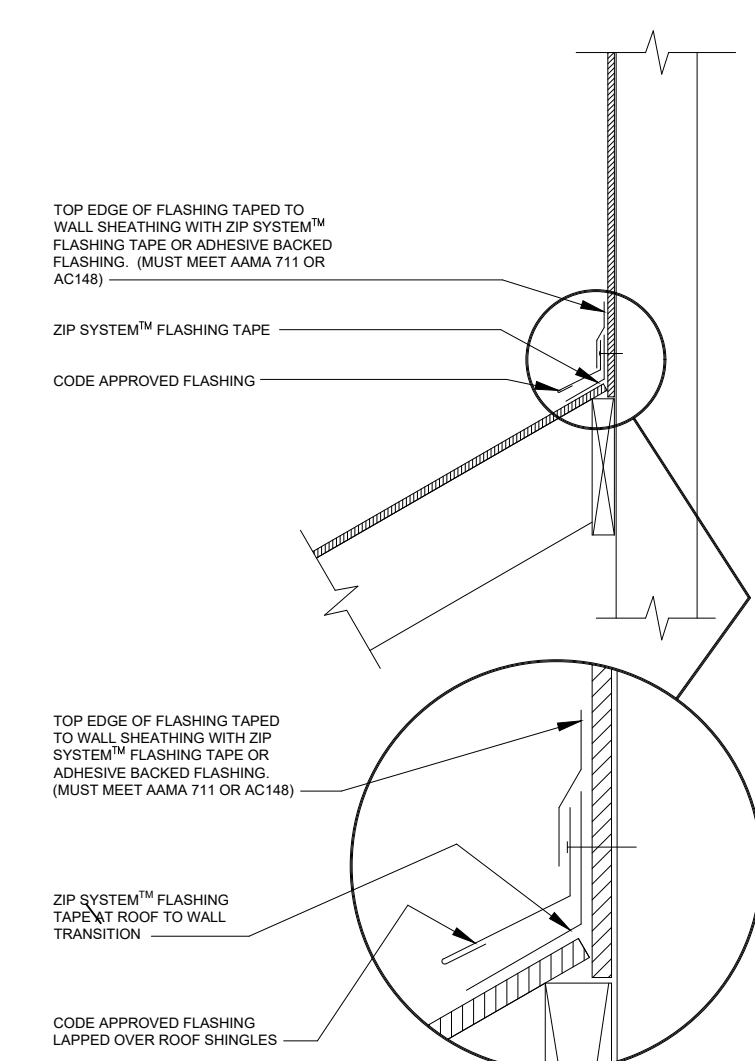

NTS

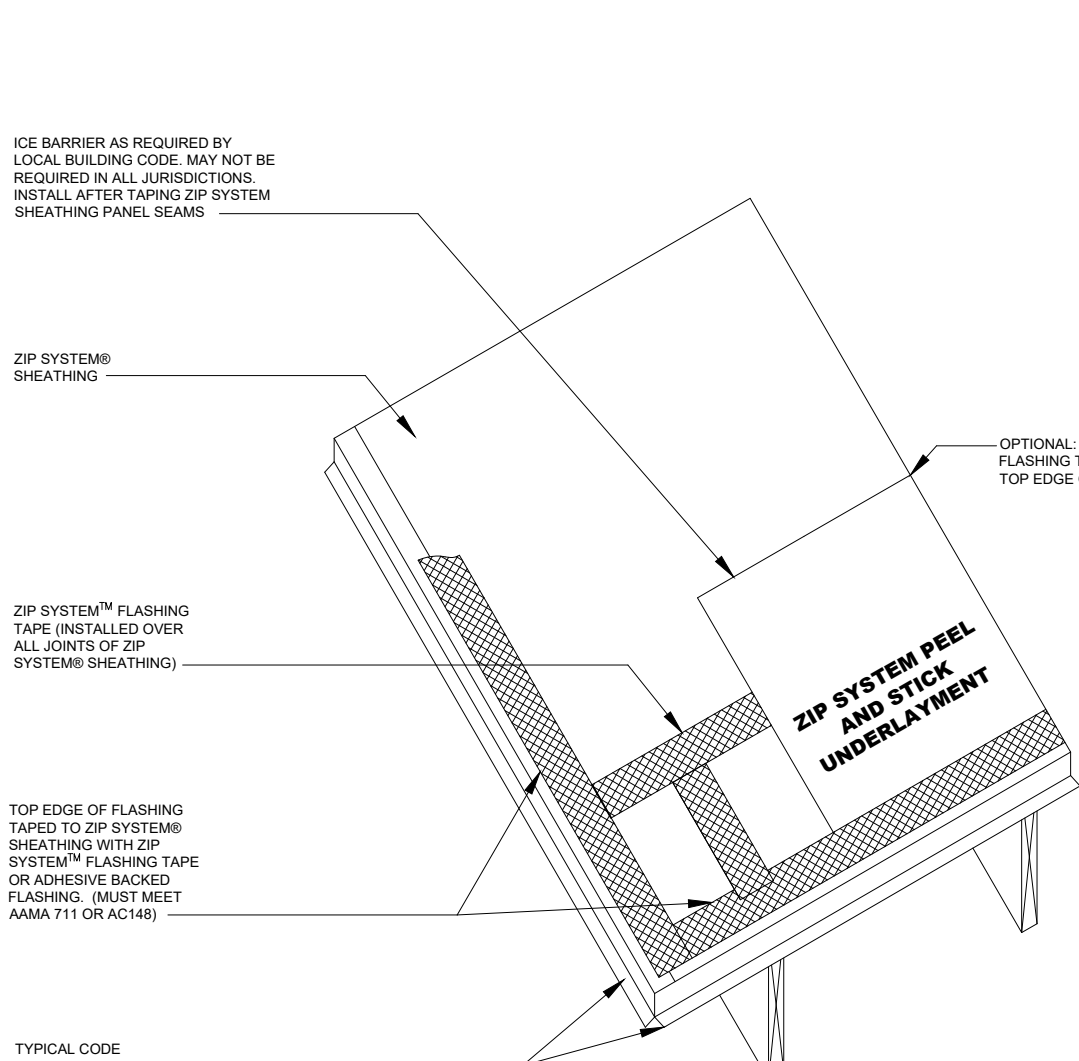

NTS

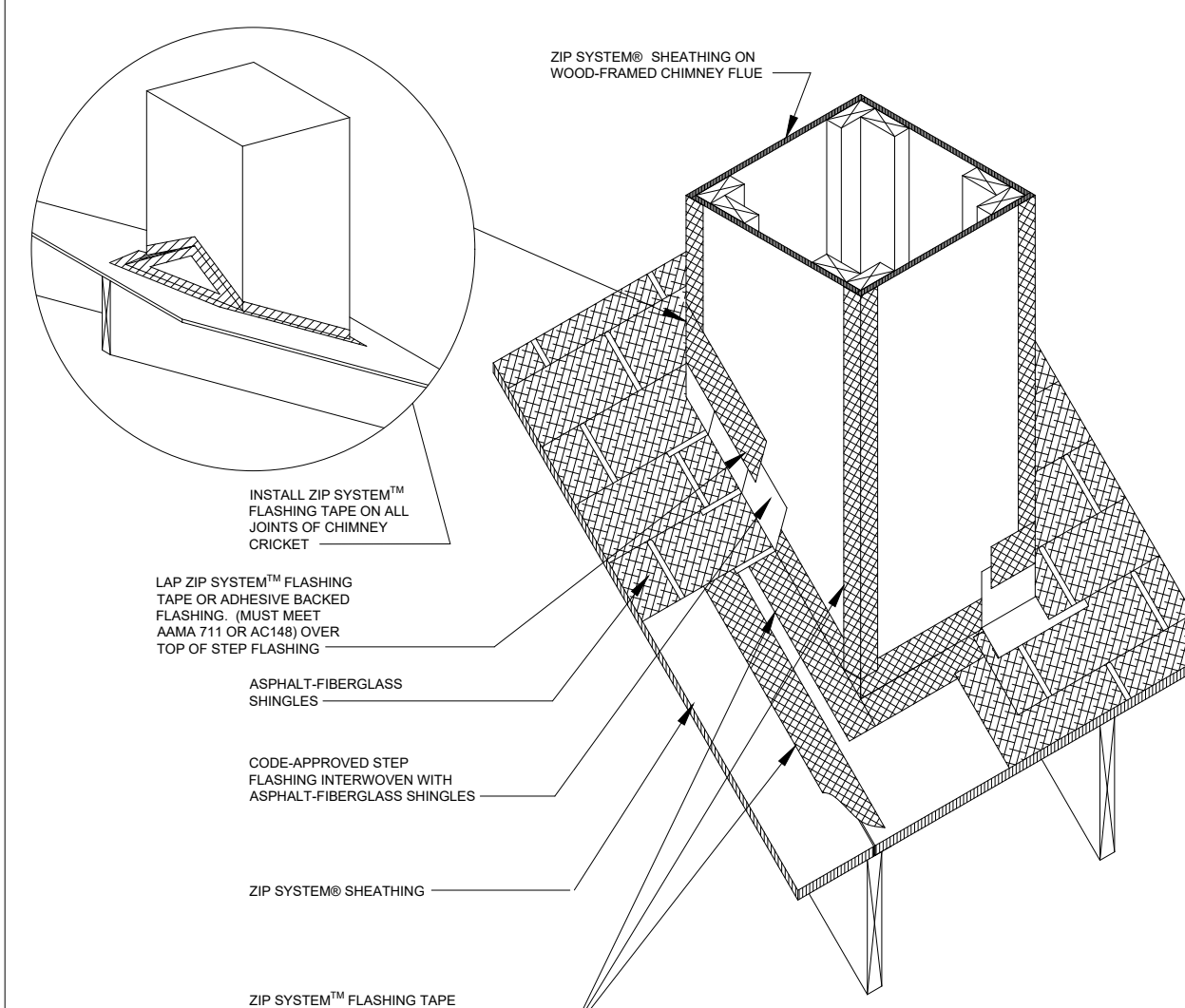

NTS

**Z-9 ZIP SYSTEM SHEATHING AT TOE BOARDS**

**Z-10 ZIP SYSTEM SHEATHING ROOF TO ZIP WALL**

**Z-11 ZIP SYSTEM SHEATHING AT ICE BARRIER**

**Z-12 ZIP SYSTEM SHEATHING AT CHIMNEY**

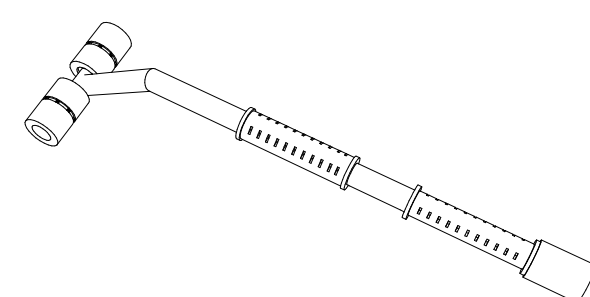

**ROLL THE TAPE**

