

Installing Housewrap over ZIP System®

ZIP System® sheathing is a combination wood structural panel with an integrated protective overlay that eliminates the need for building wrap or roofing felt. ZIP System sheathing is supported in ICC-ES ESR-1474 and ESR-3373 for ZIP System R-sheathing as an alternative to the water-resistive barrier required in Chapter 14 of the IBC, Chapter 7 of the IRC. ZIP System satisfies the air barrier requirements as defined by the ICC International Energy Conservation Code. In addition, taped ZIP System sheathing is recognized by ICC-ES ESR-1473 as an alternative to traditional roofing felt or other roof underlayment. Therefore, housewrap is not required when ZIP System sheathing is properly installed as the primary barrier in a one-layer system.

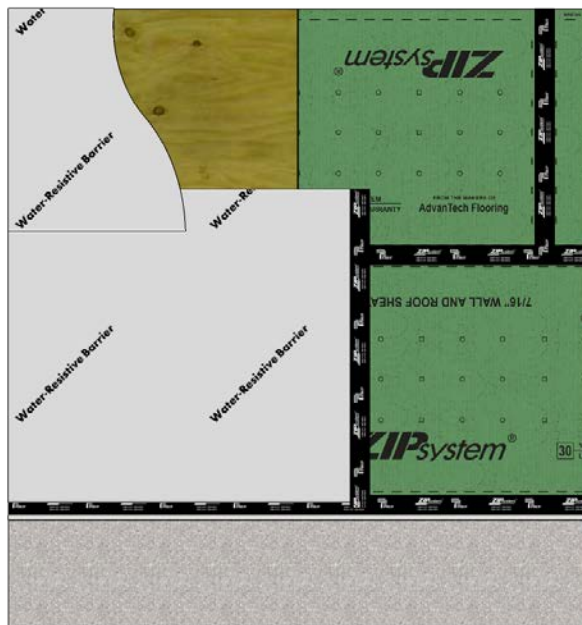
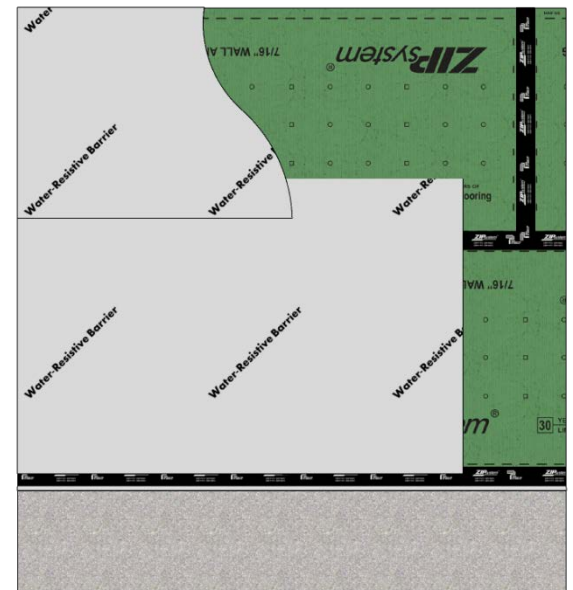

Housewrap: Housewrap is required over ZIP System sheathing or ZIP System R-sheathing when transitioning between adjacent walls where ZIP System was not used. When transitioning from ZIP System to an adjacent housewrap system, we recommend continuing the housewrap a minimum of 12 inches onto the ZIP System panels and then taping the edge of the housewrap to the ZIP System sheathing. The ZIP System flashing tape should cover at least one inch of the ZIP System panel when transitioning from housewrap to ZIP System sheathing. If ZIP System is below the housewrap system, it is recommended to leave the bottom of the housewrap untaped in order to reduce the risk of a potential ‘bladdering’ condition. This occurs when bulk water is trapped and collects between the exterior water-resistive barrier and the sheathing. The proper transitioning of housewrap to ZIP System sheathing will not void the ZIP System 30-Year Limited Warranty.

Mechanically-fastened housewrap may also be used when adhered stone, hard coat stucco or other adhered cladding is used as the exterior wall covering. Section R703.7.3 of the International Residential Code (IRC) states the requirement for two layers of a Grade D water-resistive barrier or equivalent. ZIP System sheathing or ZIP System R-sheathing performs as the primary water-resistive barrier. The second layer of water-resistive barrier acts as a ‘bond break’ between the adhered cladding and ZIP System. In addition, the installation of a drainage medium between the ZIP System sheathing or ZIP System R-sheathing and second layer of mechanically-fastened water-resistive barrier is highly recommended to increase drainage efficiency.

Huber Engineered Woods recommends installing windows prior to any housewrap installation and flashing all windows, doors, and wall penetrations back to the surface of the ZIP System in accordance with the ZIP System installation manuals. Housewrap does not qualify as a flashing tape. It is the responsibility of the general contractor to ensure all windows, doors, and wall penetrations are properly flashed to the surface of the ZIP System sheathing or ZIP System R-sheathing.

Installing a mechanically-fastened water-resistive barrier over ZIP System sheathing or ZIP System R-sheathing will not void the ZIP System 30-Year Limited Warranty. However, Huber Engineered Woods is not liable for any damages caused by improper housewrap or flashing installation. It is the responsibility of the general contractor, designer-of-record or other authority having jurisdiction to incorporate proper flashing materials and techniques when using a housewrap product over the ZIP System.

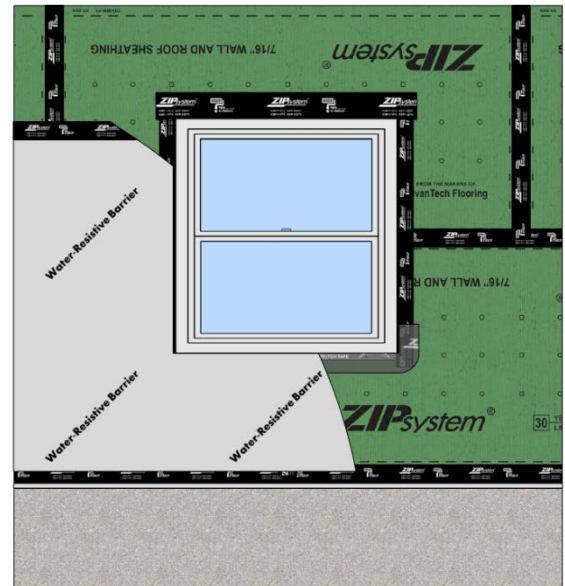

Peel-and-stick: The use of peel-and-stick membranes over the entire wall as an additional protective layer over ZIP System sheathing or ZIP System R-sheathing is not approved and will void the 30-Year ZIP System Limited Warranty. Peel-and-stick membranes minimize the ability for moisture to drain which may cause moisture to be trapped between the membrane and the face of the ZIP System. Huber Engineered Woods accepts no responsibility or liability for damages caused by the application of peel-and-stick membranes used in conjunction with ZIP System sheathing or ZIP System R-sheathing wall assemblies.

Fluid-applied: Fluid-applied water-resistive barriers should not be applied over ZIP System wall sheathing or ZIP System R-sheathing. These products reduce the ability for moisture to drain properly over the ZIP System and usually require a proprietary seam sealing material to be used in combination with the fluid-applied system. As a result, ZIP System seam sealing solutions would be omitted from the sheathing installation in order to properly install the fluid-applied system. When using ZIP System sheathing or ZIP System R-sheathing, the use of ZIP System flashing tape or ZIP System liquid flash is a requirement to maintain the ZIP System 30-Year Limited Warranty. The use of another seam sealing product will void the ZIP System 30-Year Limited Warranty. Furthermore, fluid-applied membranes may not be compatible with ZIP System flashing tape and liquid flash.

Please visit zipsystem.com or contact our technical department at 800-933-9220 Ext 2716 or at techquestions@huber.com with any questions or comments.