

Installing Housewrap over ZIP System®

ZIP System® sheathing is a combination wood structural panel with an integrated protective overlay that eliminates the need for building wrap. ZIP System sheathing is supported in ICC-ES ESR-1474 and ESR-3373 for ZIP System® R-sheathing as an alternative to the water-resistive barrier required in Chapter 14 of the International Building Code (IBC) and Chapter 7 of the International Residential Code (IRC). In addition, ZIP System satisfies the air barrier requirements as defined by the ICC International Energy Conservation Code. Taped ZIP System sheathing is recognized by ICC-ES ESR-1473 as an alternative to traditional roofing felt or other roof underlayment. Therefore, housewrap is not required when ZIP System sheathing is properly installed as the primary water-resistive barrier in a one-layer system.

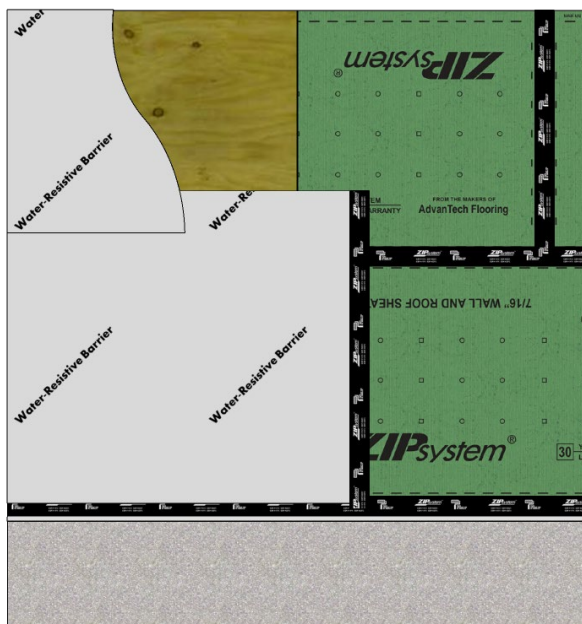
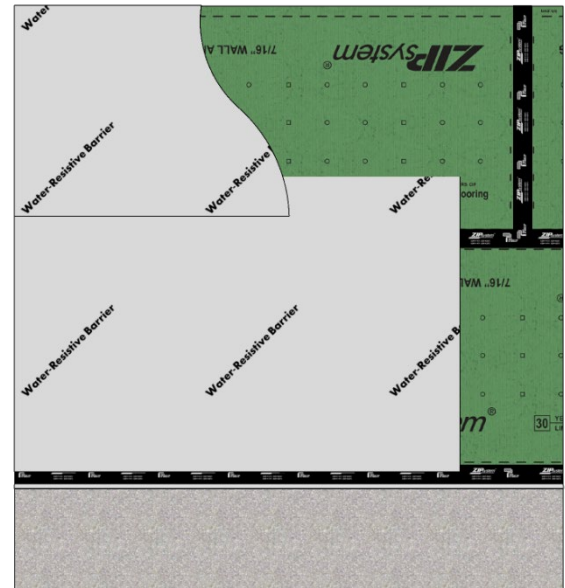

Housewrap: Housewrap is required over ZIP System sheathing or ZIP System R-sheathing when transitioning between adjacent walls where ZIP System was not used. When transitioning from ZIP System to an adjacent housewrap system, we recommend continuing the housewrap a minimum of 12 inches onto the ZIP System panels and then taping the edge of the housewrap to the ZIP System sheathing. The ZIP System flashing tape should cover at least one inch of the ZIP System panel when transitioning from housewrap to ZIP System sheathing. If ZIP System is below the housewrap system, it is recommended to leave the bottom of the housewrap untaped to reduce the risk of a potential ‘bladdering’ condition. This occurs when bulk water is trapped and collects between the exterior water-resistive barrier and the sheathing. The proper transitioning of housewrap to ZIP System sheathing will not void the ZIP System 30-Year Limited Warranty.

Mechanically-fastened housewrap may also be used when adhered stone, hard coat stucco, or other adhered cladding is used as the exterior wall covering. Section R703.7.3 of the International Residential Code (IRC) lists the water-resistive barrier requirements when exterior plaster (stucco) or other adhered claddings are to be used as the finish cladding. When installed and taped, ZIP System® sheathing or ZIP System® R-sheathing performs as the primary water-resistive barrier. The ZIP System sheathing must be separated from the stucco or adhered cladding with a layer of foam, a non-water-absorbing material, or a designated drainage space. Foam plastic insulation should not be installed over ZIP System R-sheathing. It is highly recommended to install a mechanically-fastened drainage medium like ZIP System™ rainscreen to increase drainage efficiency and drying potential.

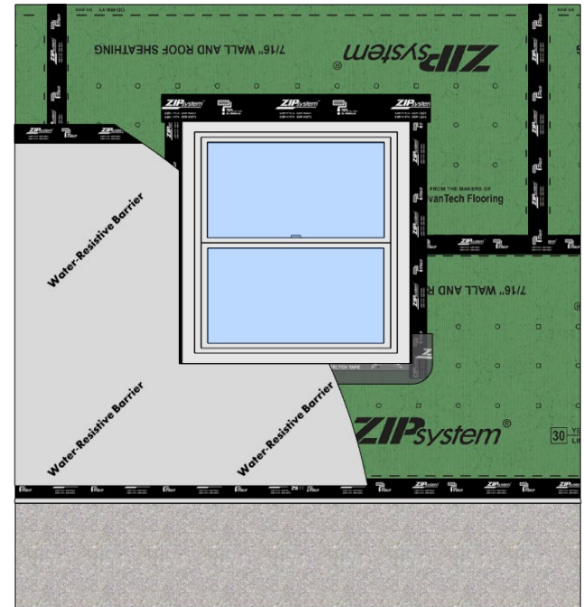

Huber Engineered Woods recommends installing windows prior to any housewrap installation and flashing all windows, doors, and wall penetrations back to the surface of the ZIP System in accordance with the governing codes, manufacturer installation guidelines, and design specifications. Housewrap does not qualify as a flashing tape. It is the responsibility of the general contractor to ensure all windows, doors, and wall penetrations are properly flashed to the surface of the ZIP System sheathing or ZIP System R-sheathing.

Installing a mechanically-fastened water-resistive barrier over ZIP System sheathing or ZIP System R-sheathing will not void the ZIP System 30-Year Limited Warranty. However, Huber Engineered Woods is not liable for any damages caused by improper housewrap or flashing installation. It is the responsibility of the general contractor, designer-of-record, or other authority having jurisdiction to incorporate proper flashing materials and techniques when using a housewrap product over the ZIP System.

Peel-and-stick: Using peel-and-stick membranes over the entire wall as an additional protective layer over ZIP System® sheathing or ZIP System® R-sheathing is not approved and will void the 30-Year ZIP System Limited Warranty. Peel-and-stick membranes minimize the ability for moisture to drain which may cause moisture to be trapped between the membrane and the face of the ZIP System. Huber Engineered Woods accepts no responsibility or liability for damages caused by the application of peel-and-stick membranes used in conjunction with ZIP System sheathing or ZIP System R-sheathing wall assemblies.

Fluid-applied: Fluid-applied water-resistive barriers should not be applied over ZIP System wall sheathing or ZIP System R-sheathing. These products reduce the ability for moisture to drain properly over the ZIP System and usually require a proprietary seam sealing material to be used in combination with the fluid-applied system. As a result, ZIP System seam sealing solutions would be omitted from the sheathing installation in order to properly install the fluid-applied system. When using ZIP System sheathing or ZIP System R-sheathing, the use of ZIP System™ flashing tape or ZIP System™ liquid flash is a requirement to maintain the ZIP System 30-Year Limited Warranty. The use of another seam sealing product will void the ZIP System 30-Year Limited Warranty. Furthermore, fluid-applied membranes may not be compatible with ZIP System flashing tape and liquid flash.

Peel-and-stick and fluid-applied membranes can be used over transitional areas (i.e. the transition from the foundation to the wall sheathing) if the material is compatible with ZIP System sheathing and ZIP System flashing and seam sealing products. In these areas, apply the peel-and-stick or fluid-applied membrane a maximum of 12 inches onto the ZIP System panel. Contact the peel-and-stick or fluid-applied material manufacturer to confirm compatibility. Please note that ZIP System™ peel and stick roof underlayment products are not permitted for use in wall applications.

Please visit zipsystem.com or contact our technical department at 800-933-9220 Ext 2716 or at techquestions@huber.com with any questions or comments.