

Concrete Slab with AdvanTech® Subflooring

There are two commonly used methods to attach AdvanTech® panels to concrete slabs. Both methods require the preparation of the slab and the use of HVAC within the structure or space.

Slab Preparation

Cover the slab using a vapor barrier with a permeance less than 0.1 perm, such as a minimum 6 mil polyethylene sheeting.

- The vapor barrier should be spot glued to the slab that will bond to both concrete and plastic. All joints in the vapor barrier should be lapped a minimum 4". These laps should also be glued to ensure an adequate moisture seal. The vapor barrier should extend up the sides of the walls a few inches. Once the AdvanTech panels are installed, the excess vapor barrier can be trimmed flush.

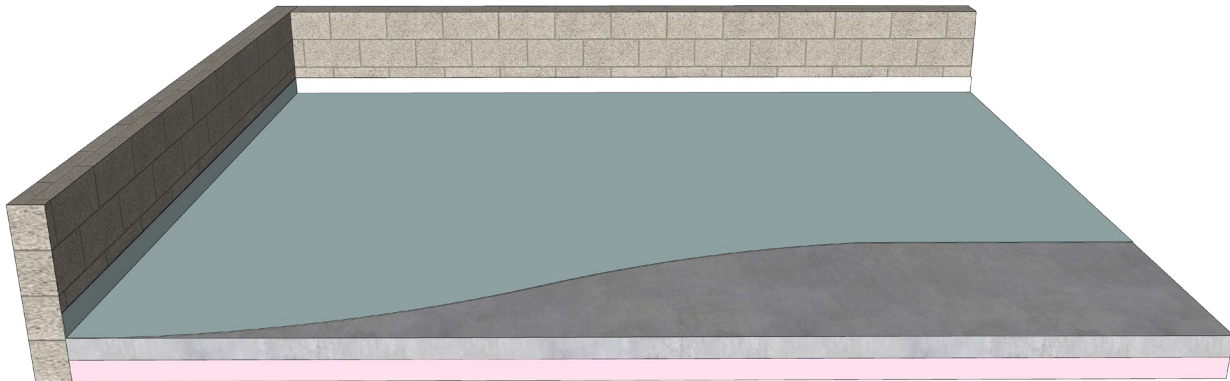

For both installation methods, the structure must be fully enclosed and dried-in prior to subfloor application. Do not install AdvanTech over a concrete slab while exposed to elements.

Method 1 - Application direct to slab

- After preparing the slab as described above, place panels directly on the vapor barrier.
- Space panels 1/8" at 4-foot ends. The T&G edge is self-spacing.
- Space panels a minimum 3/4" between AdvanTech panels and vertical obstructions or wall lines.
- Fasten panels with masonry nails, concrete fasteners or powder-actuated fasteners.
- Place fasteners 3/8" from panel edges.
- Space fasteners no more than 6" o.c. at panel edges and no more than 12" o.c. in the field. Field fastener lines should be no more than 16" apart.

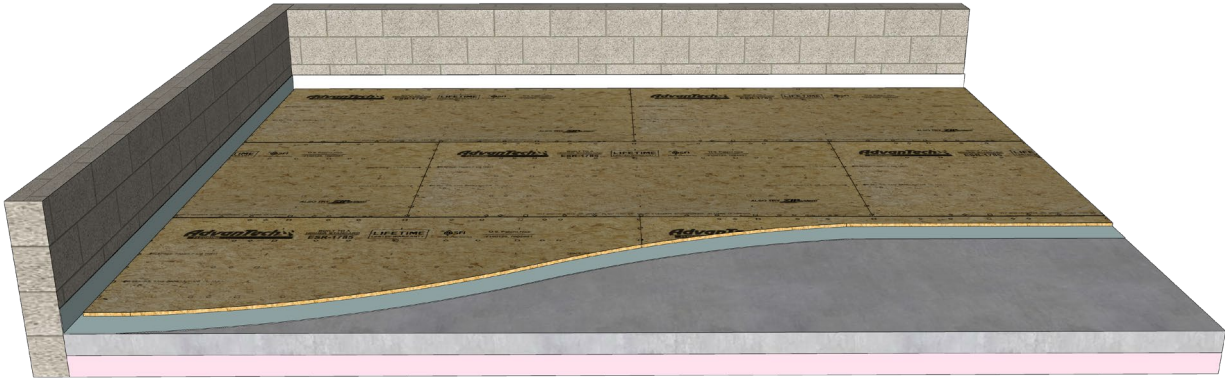

Method 2 - Application to Sleepers

- After preparing the slab as described above, install 2x4 sleepers. The recommended sleeper spacing is 16" o.c.
- Fasten sleepers to concrete slab with masonry nails, concrete fasteners or powder-actuated fasteners.
- Lay panels on joist system with long dimension across joists. All panels should cover at least 3 sleepers.
- Space panels 1/8" at 4-foot ends. The T&G edge is self-spacing.
- Fasten AdvanTech panels with #9 wood screws or 8d ring shank, screw shank or common nails that penetrate sleepers at least 1-inch. For 23/32" thick AdvanTech, fasten panels to sleepers with 6d ring shank, screw shank or common nails.
- Place fasteners 3/8" from panel edges.
- Space fasteners no more than 6" o.c. at panel edges and no more than 12" o.c. at field supports.

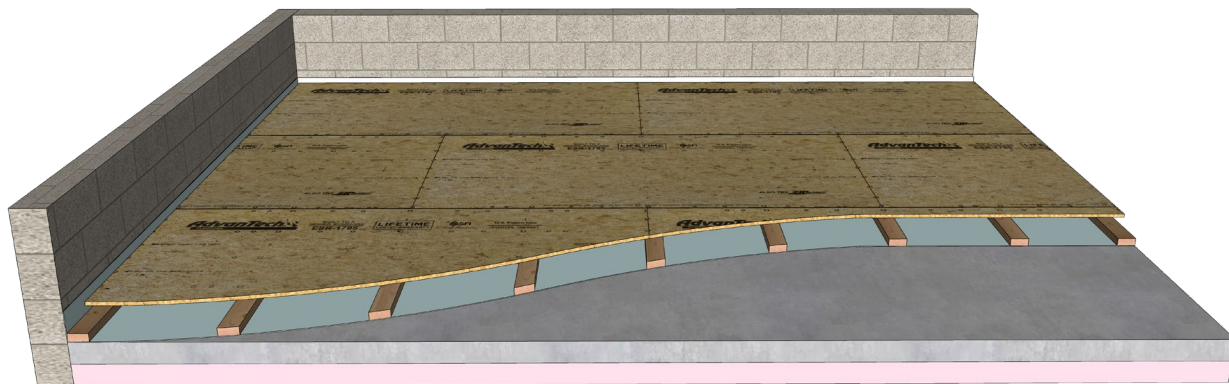

AdvanTech is a registered trademark of Huber Engineered Woods LLC