

Bottom Plate Attachment through 1/2" EXACOR™ Underlayment¹

EXACOR® underlayment panels are installed over the structural subfloor prior to the installation of bottom plates and framing. In this situation, fastener penetration into the joist, rim joist, band joist, or blocking is reduced due to the added layer of underlayment. As a result, additional fasteners must be necessary to fasten the wall bottom plate through the 1/2" EXACOR underlayment in braced and non-braced wall panel applications constructed using prescriptive methods. Attachment detail may also be engineered by a licensed design professional. The fasteners used to attach the wall bottom plate must be corrosion resistant or coated for corrosion resistance (hot-dipped galvanized or better). The fastening requirements for bottom plate attachment to 1/2" EXACOR panels are explained and illustrated below.

¹This technical tip addresses the bottom plate attachment for 1/2" EXACOR underlayment, only. For EXACOR panels used as underlayment that are 5/8" or thicker, bottom plate attachment must be detailed by a licensed design professional.

Non-Braced Wall Panel Applications

For non-braced wall panels, the bottom plate should be attached with a minimum two corrosion-resistant (hot-dipped galvanized or better) 16d common nails (3.5-inch x 0.162-inch) spaced 16 inches on center.

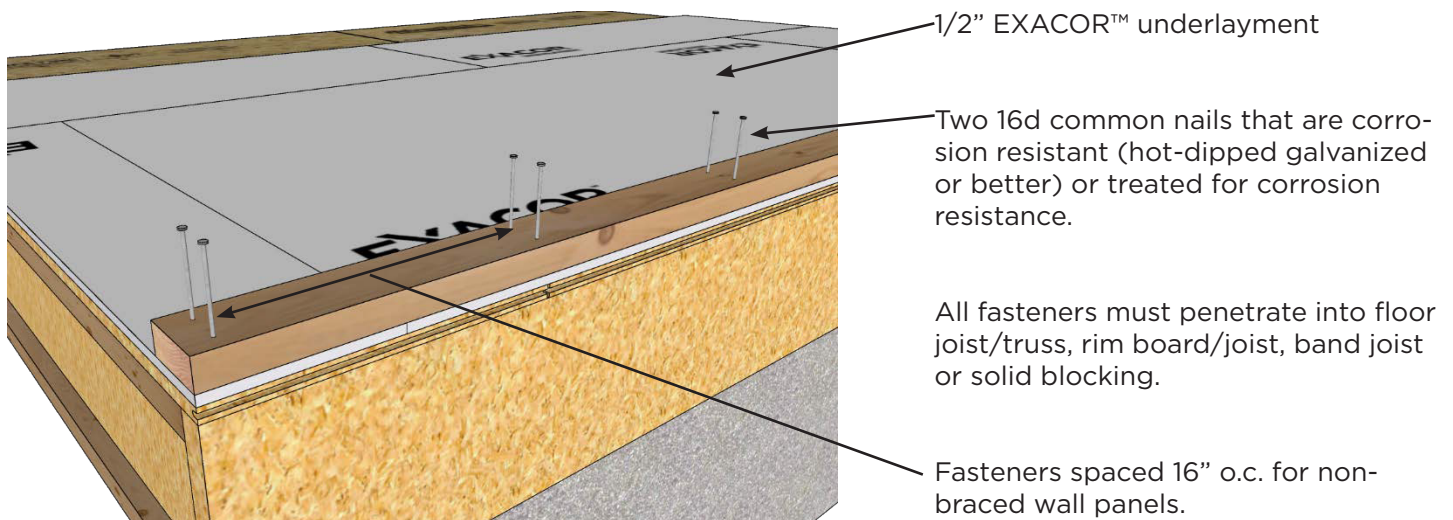

*Wall studs not shown for clarity

Braced Wall Panel Applications

For braced wall panels, the bottom plate should be attached with a minimum two corrosion-resistant (hot-dipped galvanized or better) 16d common nails (3.5-inch x 0.162-inch) spaced 8 inches on center.

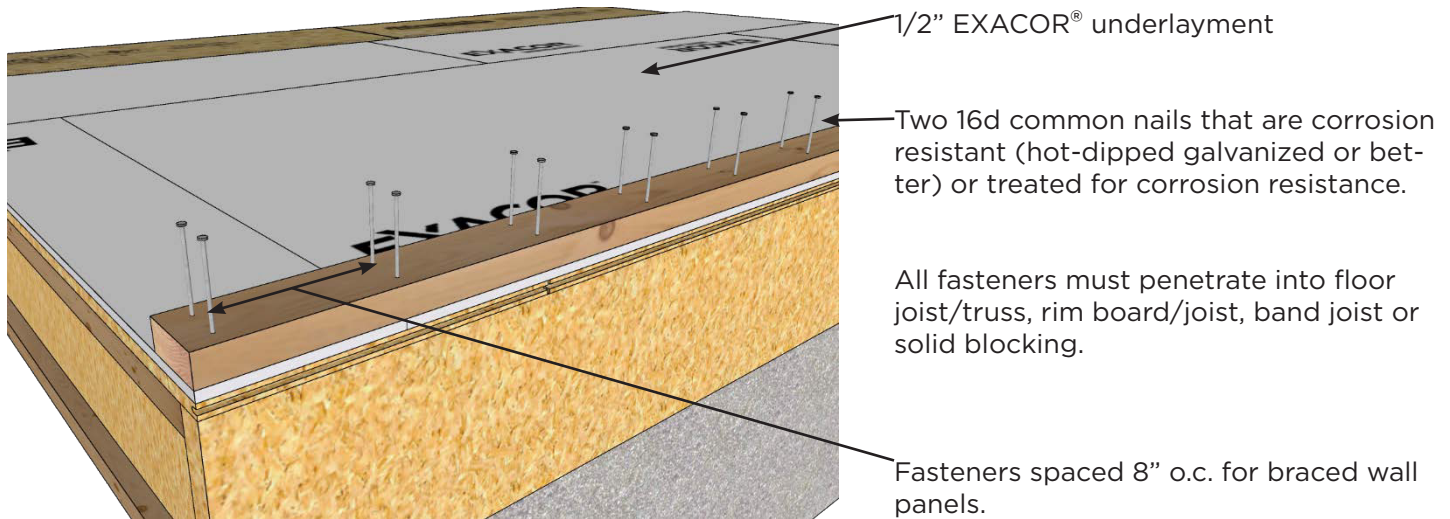

*Wall studs not shown for clarity