

1. ZIP SYSTEM™ TAPE.
2. ZIP SYSTEM™ ROLLER. ROLL ALL TAPE.

TIP: WHEN INSTALLING ZIP SYSTEM™ TAPE ON AN INSIDE CORNER USE ARM LENGTHS PORTIONS OF TAPE AT A TIME. WORK THE TAPE INTO THE CORNER USING A TOOL SUCH AS A PLASTIC SPEED SQUARE TO ENSURE A TIGHT CORNER IS INSTALLED.

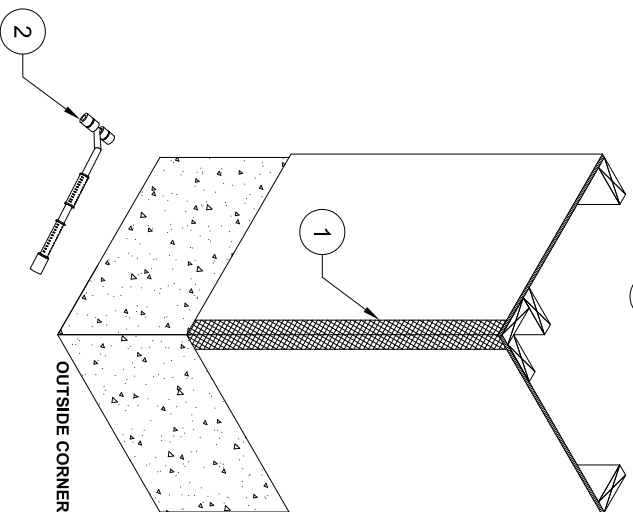
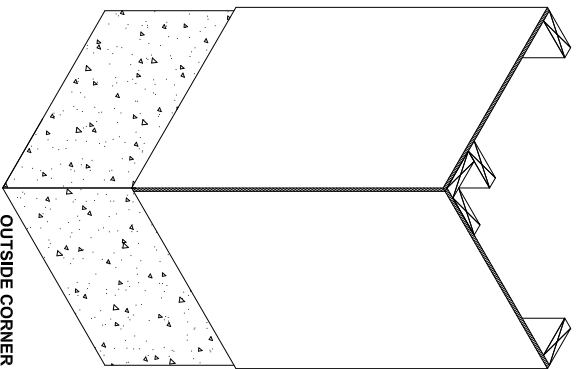
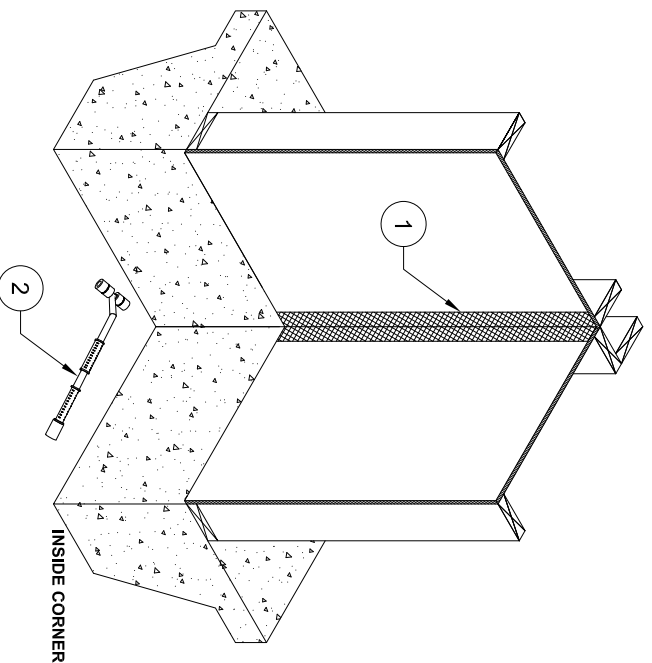
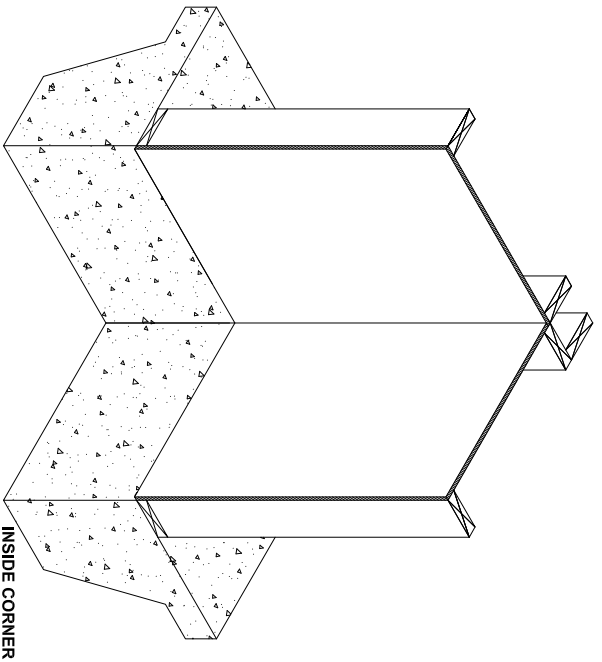

NTS