

# ENERGY SAVINGS AND COMFORT ARE BUILT RIGHT IN WITH ZIP SYSTEM® WALL SHEATHING.



**ZIPsystem™**  
ROOF & WALL SHEATHING  
FROM THE CREATORS OF ADVANTECH® FLOORING



Building site courtesy of Miller & Smith.

Utility prices are on the rise. So it's no surprise that energy efficiency is the first thing that comes to mind when building a new home.

A little known fact is that heating and cooling account for an incredible 50% to 70% of the total energy used in the average home. Air leakage is one of the most significant contributors to this waste. The science behind ZIP System sheathing is the solution.

## WHAT IS ZIP SYSTEM WALL SHEATHING?

ZIP System Wall sheathing is an easy to install structural engineered wood panel with a water-resistive barrier and air barrier built right in. When used in conjunction

with ZIP System™ tape, a seamless protective surface is achieved, resulting in a superior level of insulation.

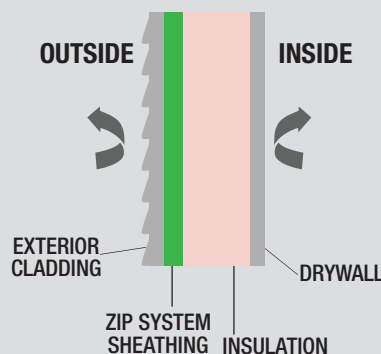

**ZIPsystem™**  
ESR 1474  
ESR 1474  
ESR 1474

**ZIPsystem™**  
ESR 1474  
ESR 1474  
ESR 1474

**ZIPsystem™**

# SEE WHAT YOU CAN SAVE

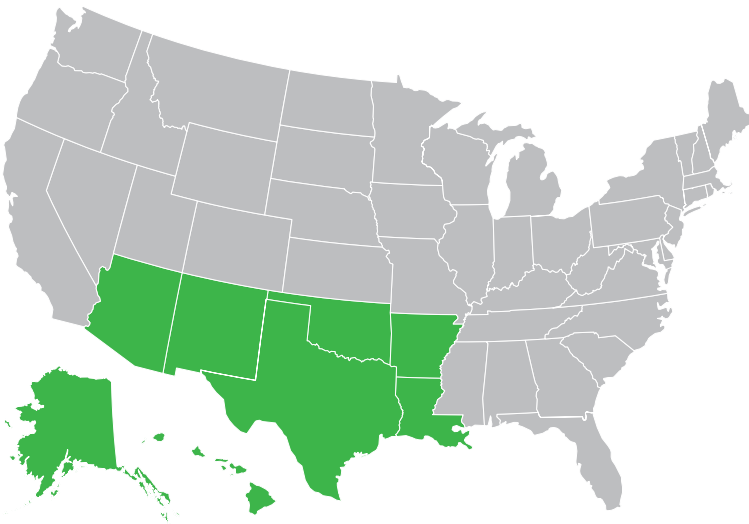

| CITY          | AVERAGE ANNUAL SAVINGS ON HEATING AND COOLING COSTS | ANNUAL ZIP SYSTEM WALL SAVINGS (\$ SAVINGS) |
|---------------|---|---|
| NEW ORLEANS   | <b>5.8%</b>   | \$74  |
| DALLAS        | <b>6.7%</b>   | \$125                                       |
| LITTLE ROCK   | <b>7.2%</b>   | \$136                                       |
| OKLAHOMA CITY | <b>9.4%</b>   | \$183                                       |
| OMAHA         | <b>11.6%</b>  | \$177                                       |

Calculations are estimated, based on a 2 story, 3,200 sq./ft home on slab foundation with gas heat and central air. Based on the following average utility prices: Electricity: 0.0750 \$/kWh Gas: 10.67 \$/mcf

## HOW DOES IT WORK?

The technology behind ZIP System sheathing helps eliminate gaps in what is known as the 'building envelope', reducing air leakage from areas such as wall joints. ZIP System Wall sheathing is so advanced; it eliminates the need for conventional housewrap, once and for all.

## FOR A HOMEOWNER, A TIGHTER HOME MEANS:

- **Energy savings-** Homeowners with ZIP System sheathing save an average of 10.5% on their utility bills.
- **Increased comfort inside the home-** Protecting against air leakage and drafts leads to a more comfortable living space where it counts the most.
- **Improved air quality-** Air barrier systems such as ZIP System Wall sheathing keep families safe by protecting them against harmful pollutants.

## WHAT IS THE R-VALUE AND HOW DO WE PROTECT IT?

R-value (also known as the resistance value) is the way the building industry measures the inherent thermal resistance of insulation. The higher the R-value, the greater the resistance to heat flowing through the wall cavity. Air leakage lessens the ability of insulation to do its job, namely to resist heat flow. The solution is an efficient wall system that creates a tight seal and allows insulation to perform at its intended level. ZIP System Wall sheathing is one of the easiest, most efficient ways to seal the wall system and prevent air leakage from degrading the R-value.



For more information, visit [www.zipsystem.com/energyefficiency](http://www.zipsystem.com/energyefficiency)

Sales Office: 10925 David Taylor Drive, Suite 300 Charlotte, NC 28262 Telephone: 800.933.9220 Fax: 704.547.9228 [www.zipsystem.com](http://www.zipsystem.com)



© 2013 Huber Engineered Woods LLC. ZIP System, the accompanying ZIP System logo and design are trademarks of Huber Engineered Woods LLC. Huber is a registered trademark of J.M. Huber Corporation. Patents Pending. HUB11-02/13-SW

Limitations and restrictions apply - visit [zipsystem.com](http://zipsystem.com) for details.

